



Venue

Kyoto pref.
Kyoto City

Masters Village Kyoto

Porta Underground Shopping Mall – Kyoto Station
「Porta Plaza」

902 Higashishiokojicho, Shimogyo-ku, Kyoto City
<http://www.porta.co.jp/floor>

■ Access to Masters Village Kyoto

✈ From Kansai International Airport

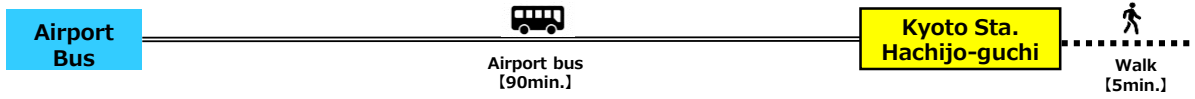

✈ From Osaka International Airport (Itami Airport)

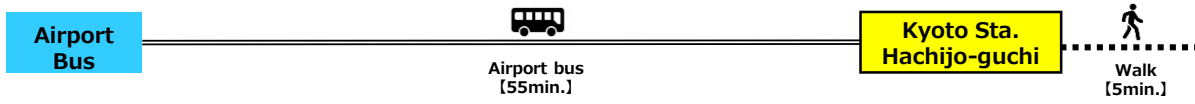

Porta Underground Shopping Mall – Kyoto Station 「Porta Plaza」

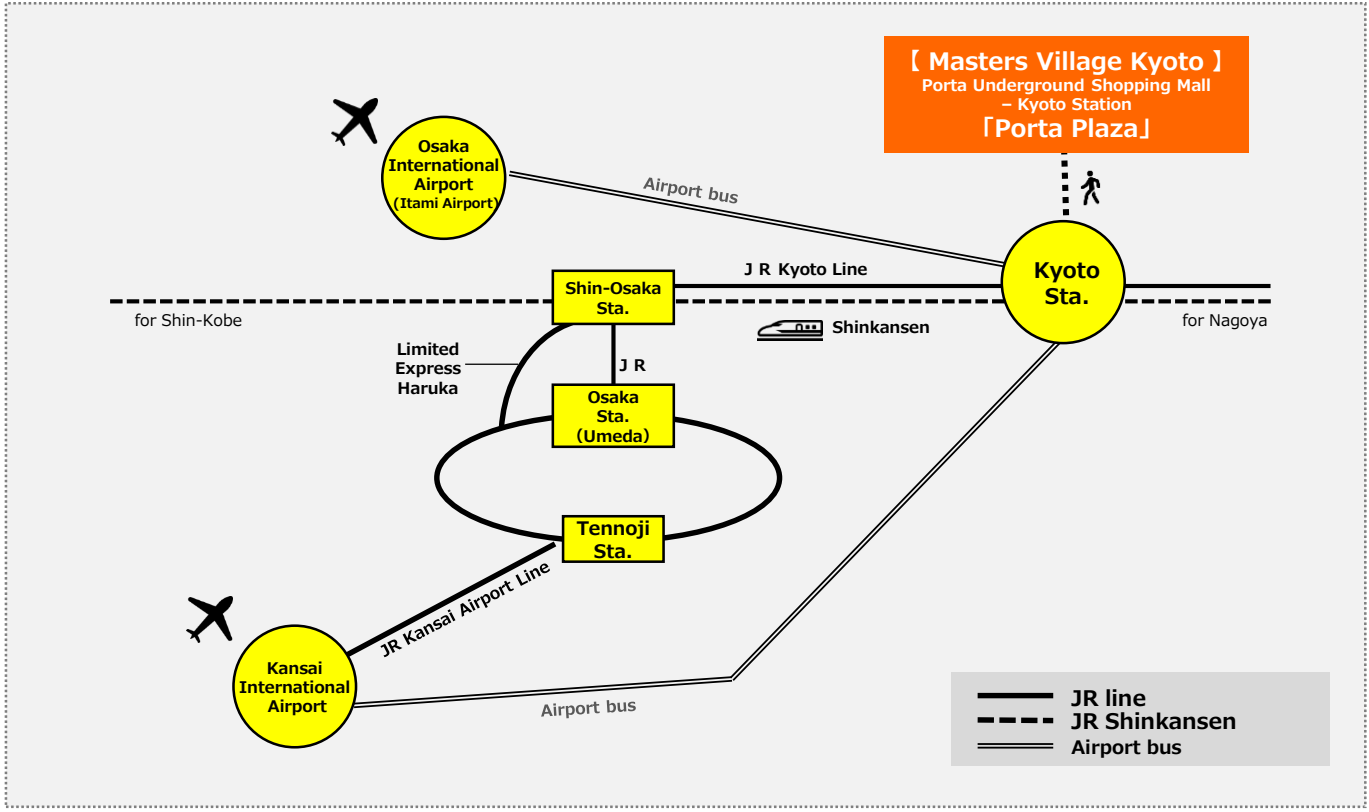

■ Access map to Masters Village

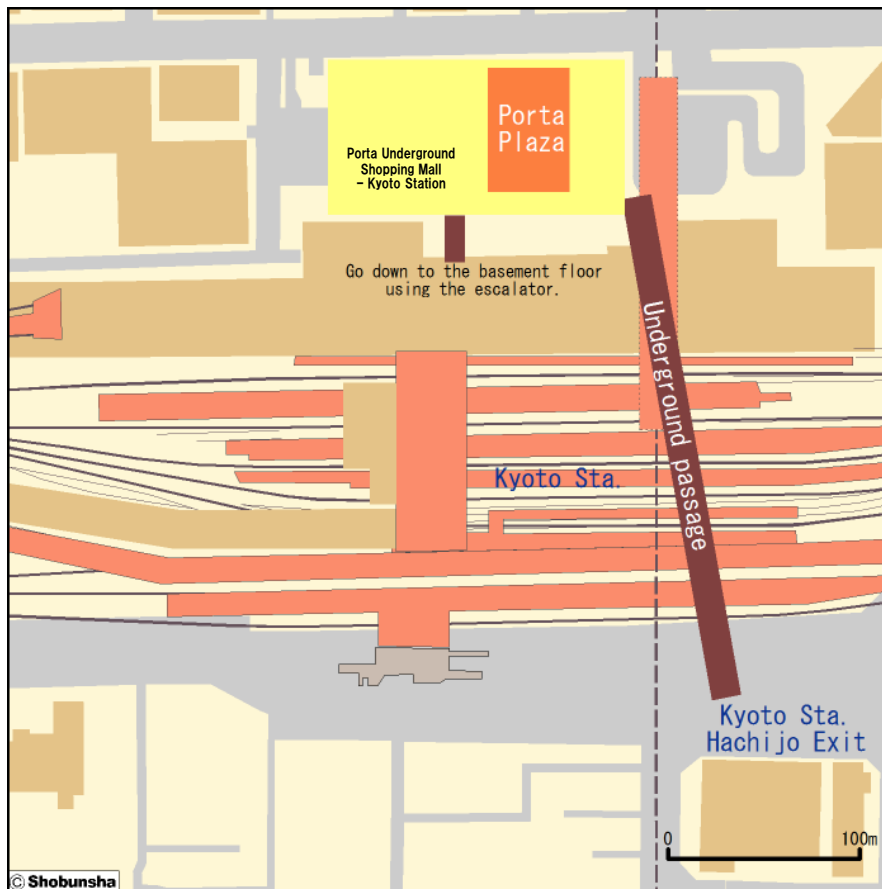

■ Transportation information to Masters Village Kyoto (Porta Underground Shopping Mall - Kyoto Station 「Porta Plaza」)

- From JR Kyoto Station, take the central exit and go down to the basement level using the escalator. Turn right at the first passage and proceed straight ahead. The next square is "Porta Plaza".
- From the airport bus drop-off location "Kyoto Station Hachijo-guchi", proceed to "Hachijo East Exit" of Kyoto Station and go down to the 2nd basement level. Please proceed straight through the underground passage. "Porta Plaza" is on the left at the north gate of Subway Kyoto Station.

■ Other traffic precautions

Transport passes(original KANSAI ONE PASS, original JR Kansai Wide Area Pass) will be delivered to Center Village's or Masters Village's Games Check-in if you have applied in advance.

※ Please note that if you purchase a similar transportation pass, the services will overlap.

Please contact Gateway Information for directions to Masters Village.

※ Gateway Information are located at Kansai International Airport and Osaka International Airport, JR Kyoto Station.

As of February 1, 2020

